

36 241 000 EUROPLUS E CONCEALED MOUNTING BOX 1/2"

SPARE PARTS, January 2001 – now

- 1: Supply stop for warm water (Spare part-nr. 42116000)
- 2: Filter (Spare part-nr. 4212400M)
- 3: Connecting hose (Spare part-nr. 42117000)
- 3.1: Fibre seal dia. Ø 18,5 x Ø 12 x 2 (Spare part-nr. 0138900M)
- 4: plug-in connector (Spare part-nr. 42732000)
- 5: Fixing set (Spare part-nr. 4352800M)

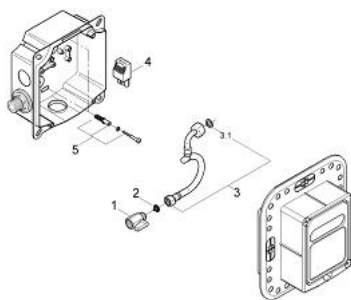

36 241 000 EUROPLUS E CONCEALED MOUNTING BOX 1/2"

SPARE PARTS, December 2008 – now

- 1: Supply stop for warm water (Spare part-nr. 42116000)
- 2: Filter (Spare part-nr. 4215200M)
- 3: Connecting hose (Spare part-nr. 42117000)
- 3.1: Fibre seal dia. Ø 18,5 x Ø 12 x 2 (Spare part-nr. 0138900M)
- 4: Transformer connecting box (Spare part-nr. 42279000)

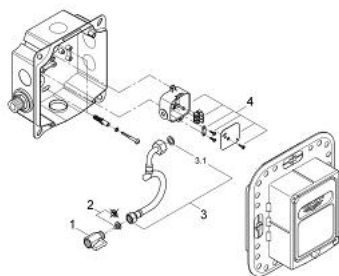

36 241 000 EUROPLUS E CONCEALED MOUNTING BOX 1/2"

SPARE PARTS, June 2008 – December 2008

- 1: Supply stop for warm water (Spare part-nr. 42116000)
- 2: Filter (Spare part-nr. 4212400M)
- 3: Connecting hose (Spare part-nr. 42117000)
- 3.1: Fibre seal dia. Ø 18,5 x Ø 12 x 2 (Spare part-nr. 0138900M)
- 4: Transformer connecting box (Spare part-nr. 42279000)

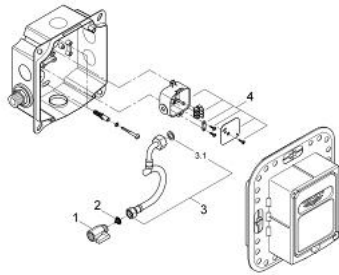

36 241 000 EUROPLUS E CONCEALED MOUNTING BOX 1/2"

SPARE PARTS, January 2006 – June 2008

- 1: Supply stop for warm water (Spare part-nr. 42116000)
- 2: Filter (Spare part-nr. 4212400M)
- 3: Connecting hose (Spare part-nr. 42117000)
- 3.1: Fibre seal dia. Ø 18,5 x Ø 12 x 2 (Spare part-nr. 0138900M)
- 4: Transformer connecting box (Spare part-nr. 42279000)
- 5: Fixing set (Spare part-nr. 4352800M)

