

36 016 001 EUROPLUS E INFRA-RED ELECTRONIC BASIN TAP 1/2"

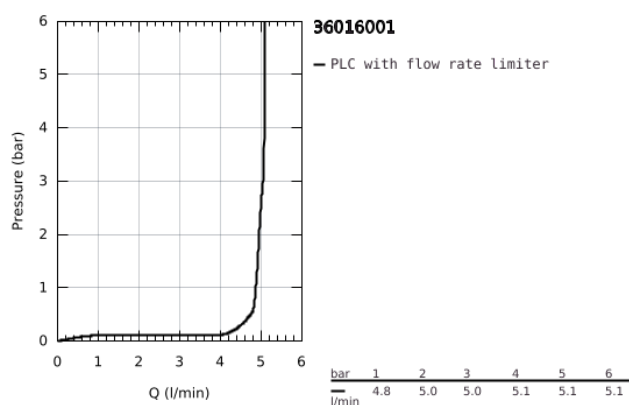

PRODUCT DESCRIPTION

- Colour: Chrome
- with infrared sensor for bi-directional communication for monitoring, configuration and servicing
- for cold or premixed water
- without power supply 36 338 000 (required)
- GROHE Water Saving - Less water, perfect flow
- maximum flow rate (at 3 bar): 5 l/min
- flexible connection hoses
- dirt strainer
- solenoid valve
- rapid installation system
- 7 pre-set programs
- auto flush
- thermal disinfection
- cleaning mode
- additional functions and precise settings by remote control 36 407
- CE approved
- noise classification 1 in accordance with DIN4109
- type of protection faucet IP 59K

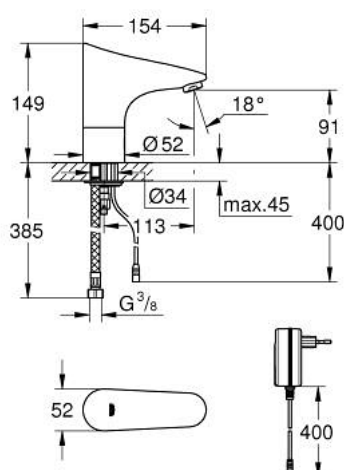

36 016 001 EUROPLUS E INFRA-RED ELECTRONIC BASIN TAP 1/2"

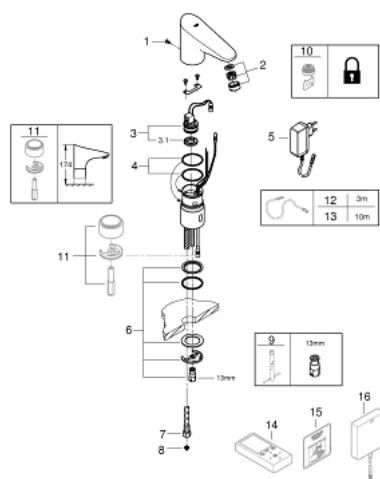

SPARE PARTS, August 2016 – now

- 1: Screw (Spare part-nr. 4283100M)
- 2: Flow restrictor (Spare part-nr. 48159000)
- 3: Solenoid valve (Spare part-nr. 42229000)
- 3.1: Filter (Spare part-nr. 42798000)
- 4: O-Ring (Spare part-nr. 4283600M)
- 5: Mains adaptor (Spare part-nr. 42388000)
- 6: Fixing set (Spare part-nr. 42841000)
- 7: Connection hose (Spare part-nr. 46255000)
- 8: Filter (Spare part-nr. 4215200M)
- 9: Mounting wrench (Spare part-nr. 19017000)*
- 10: Flow restrictor (Spare part-nr. 36133000)*
- 11: Socket for spout elevation (Spare part-nr. 36210000)*
- 12: Power extension cable (Spare part-nr. 36340000)*
- 13: Power extension cable (Spare part-nr. 36341000)*
- 14: Remote control (Spare part-nr. 36407001)*
- 15: Sticker with pictograph (Spare part-nr. 4217700M)*
- 16: Switch mode power supply (Spare part-nr. 36338000)*

* Optional accessories