

34 254 000 GROHTHERM 2000 SPECIAL THERMOSTATIC BATH/SHOWER MIXER 1/2"

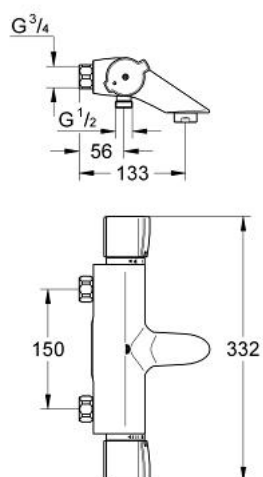

PRODUCT DESCRIPTION

- Colour: Chrome
- wall mounted
- GROHE CoolTouch safety housing
- metal wing handles
- GROHE TurboStat compact cartridge with wax thermoelement
- integrated mixed water shut off
- ceramic headpart 1/2", 180°
- Aquadimmer handle with multiple function
- - flow control
- - diverter: bath/shower
- temperature scale handle with pre-adjustable safety stop between 35°C and 43°C
- easy thermal disinfection with accessory handle 47 764 000
- shower bottom outlet 1/2"
- mousseur
- built-in non return valves
- without connection unions
- without escutcheons
- protected against backflow
- dirt strainers
- GROHE Long-Life finish

34 254 000 GROHTHERM 2000 SPECIAL THERMOSTATIC BATH/SHOWER MIXER 1/2"

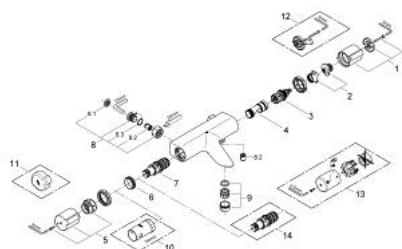

SPARE PARTS, March 2007 – now

- 1: Aquadimmer handle (Spare part-nr. 47779000)
 - 2: Temperature limiter (Spare part-nr. 47750000)
 - 3: Aquadimmer (Spare part-nr. 12433000)
 - 4: Water flow (Spare part-nr. 47751000)
 - 5: Temperature knob with metal end stop (Spare part-nr. 47733000)
 - 6: retaining ring (Spare part-nr. 47743000)
 - 7: Thermostatic compact cartridge 1/2" (Spare part-nr. 47439000)
 - 8: Non-return valve (Spare part-nr. 47189000)
 - 8.1: Filter (Spare part-nr. 0726400M)
 - 8.2: Non-return valve (Spare part-nr. 08565000)
 - 8.3: O-Ring Ø17 x Ø2 (Spare part-nr. 0305500M)
 - 9: Flow restrictor (Spare part-nr. 13927000)
 - 10: Socket Spanner (Spare part-nr. 19332000)*
 - 11: Unlocking handle (Spare part-nr. 47764000)*
 - 12: Handle for disabled use (Spare part-nr. 47735000)*
 - 13: Metal handle temperature control (Spare part-nr. 47763000)*
 - 14: GROHE TurboStat cartridge 1/2" (Spare part-nr. 47175000)*
- * Optional accessories