

## 34 169 000 GROHTHERM 2000 THERMOSTATIC SHOWER MIXER 1/2"

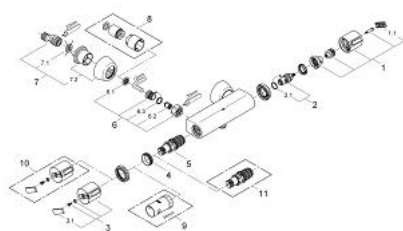

### SPARE PARTS, April 2007 – now

- 1: Handle for shut-off valve with economy device (Spare part-nr. 47745000)
- 1.1: Cover Cap (Spare part-nr. 1007500M)
- 2: Ceramic headpart, 1/2" (Spare part-nr. 45346000)
- 2.1: O-Ring Ø18,2 x Ø1,7 (Spare part-nr. 0392400M)
- 3: Temperature scale handle (Spare part-nr. 47742000)
- 3.1: Cover Cap (Spare part-nr. 1007500M)
- 4: retaining ring (Spare part-nr. 47743000)
- 5: Thermostatic compact cartridge 1/2" (Spare part-nr. 47439000)
- 6: Non-return valve (Spare part-nr. 47189000)
- 6.1: Filter (Spare part-nr. 0726400M)
- 6.2: Non-return valve (Spare part-nr. 08565000)
- 6.3: O-Ring Ø17 x Ø2 (Spare part-nr. 0305500M)
- 7: S-union (Spare part-nr. 12058000)
- 7.1: Sealing washer (Spare part-nr. 0138600M)
- 7.2: Covering escutcheon (Spare part-nr. 45545000)
- 8: Extension 30 (Spare part-nr. 46238000)\*
- 9: Socket Spanner (Spare part-nr. 19332000)\*
- 10: Temperature scale handle (Spare part-nr. 47286000)\*
- 11: GROHE TurboStat cartridge 1/2" (Spare part-nr. 47175000)\*

\* Optional accessories

## 34 169 000 GROHTHERM 2000 THERMOSTATIC SHOWER MIXER 1/2"

### SPARE PARTS, December 2006 – April 2007

1: Handle for shut-off valve with economy device (Spare part-nr. 47745000)

1.1: Cover Cap (Spare part-nr. 1007500M)

2: Ceramic headpart, 1/2" (Spare part-nr. 45346000)

3: Temperature scale handle (Spare part-nr. 47742000)

3.1: Cover Cap (Spare part-nr. 1007500M)

4: retaining ring (Spare part-nr. 47743000)

5: Thermostatic compact cartridge 1/2" (Spare part-nr. 47439000)

6: Non-return valve (Spare part-nr. 47189000)

6.1: Filter (Spare part-nr. 0726400M)

6.2: Non-return valve (Spare part-nr. 08565000)

6.3: O-Ring Ø17 x Ø2 (Spare part-nr. 0305500M)

7: S-union (Spare part-nr. 12058000)

7.1: Sealing washer (Spare part-nr. 0138600M)

7.2: Covering escutcheon (Spare part-nr. 45545000)

8: Extension 30 (Spare part-nr. 46238000)\*

9: Socket Spanner (Spare part-nr. 19332000)\*

10: Temperature scale handle (Spare part-nr. 47286000)\*

11: GROHE TurboStat cartridge 1/2" (Spare part-nr. 47175000)\*

\* Optional accessories

No exploded view is available for this spare part list.

## 34 169 000 GROHTHERM 2000 THERMOSTATIC SHOWER MIXER 1/2"

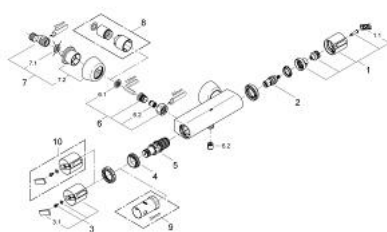

### SPARE PARTS, February 2004 – December 2006

- 1: Handle for shut-off valve with economy device (Spare part-nr. 47745000)
- 1.1: Cover Cap (Spare part-nr. 1007500M)
- 2: Ceramic headpart, 1/2" (Spare part-nr. 45346000)
- 3: Temperature scale handle (Spare part-nr. 47742000)
- 3.1: Cover Cap (Spare part-nr. 1007500M)
- 4: retaining ring (Spare part-nr. 47743000)
- 5: Thermostatic compact cartridge 1/2" (Spare part-nr. 47439000)
- 6: Non-return valve (Spare part-nr. 47189000)
- 6.1: Filter (Spare part-nr. 0726400M)
- 6.2: Non-return valve (Spare part-nr. 08565000)
- 6.3: O-Ring Ø17 x Ø2 (Spare part-nr. 0305500M)
- 7: S-union (Spare part-nr. 12058000)
- 7.1: Sealing washer (Spare part-nr. 0138600M)
- 7.2: Covering escutcheon (Spare part-nr. 45545000)
- 8: Extension 30 (Spare part-nr. 46238000)\*
- 9: Socket Spanner (Spare part-nr. 19332000)\*
- 10: Temperature scale handle (Spare part-nr. 47286000)\*
- \* Optional accessories