

33 562 000 **ESSENCE BASIN MIXER 1/2"**
S-SIZE

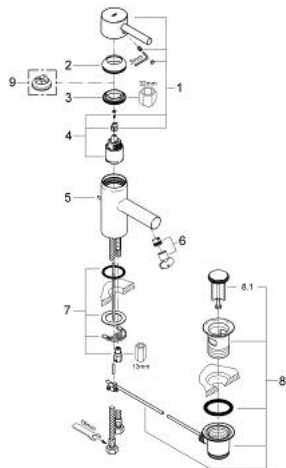

SPARE PARTS, July 2008 – now

- 1: Lever (Spare part-nr. 46535000)
- 2: Shield for cross handle (Spare part-nr. 46436000)
- 3: Screw coupling (Spare part-nr. 46460000)
- 4: Cartridge (Spare part-nr. 46374000)
- 5: Pop-up rod (Spare part-nr. 10769000)
- 6: Mousseur set (Spare part-nr. 13937000)
- 7: Shank mounting kit (Spare part-nr. 46249000)
- 8: Pop-up waste set (Spare part-nr. 28915000)
- 8.1: Chrome bath plug (Spare part-nr. 45210000)
- 9: Temperature limiter (Spare part-nr. 46375000)*

* Optional accessories

33 562 000 ESSENCE BASIN MIXER 1/2" S-SIZE

No exploded view is available for this spare part list.

SPARE PARTS, November 2007 – July 2008

- 1: Lever (Spare part-nr. 46535000)
- 2: Shield for cross handle (Spare part-nr. 46436000)
- 3: Screw coupling (Spare part-nr. 46460000)
- 4: Cartridge (Spare part-nr. 46374000)
- 5: Pop-up rod (Spare part-nr. 10769000)
- 6: Mousseur set (Spare part-nr. 13937000)
- 7: Shank mounting kit (Spare part-nr. 46249000)
- 8: Pop-up waste set (Spare part-nr. 28915000)
- 8.1: Chrome bath plug (Spare part-nr. 45210000)
- 9: Temperature limiter (Spare part-nr. 46375000)*

* Optional accessories

33 562 000 **ESSENCE BASIN MIXER 1/2"**
S-SIZE

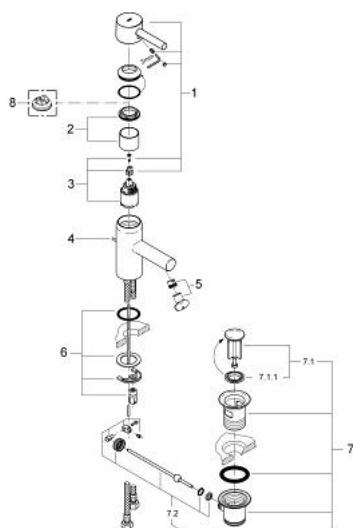

SPARE PARTS, January 2005 – November 2007

- 1: Lever (Spare part-nr. 46535000)
- 2: Screw coupling (Spare part-nr. 46460000)
- 3: Cartridge (Spare part-nr. 46374000)
- 4: Pop-up rod (Spare part-nr. 10769000)
- 5: Mousseur set (Spare part-nr. 13937000)
- 6: Shank mounting kit (Spare part-nr. 46447000)
- 7: Pop-up waste set 1 1/4" (Spare part-nr. 28910000)
- 7.1: Chrome bath plug (Spare part-nr. 07182000)
- 7.2: Eccentric rod (Spare part-nr. 07052000)
- 8: Temperature limiter (Spare part-nr. 46375000)*

* Optional accessories