

- Colour: Chrome
- for use with displacement water heater
- C-spout
- monobloc installation
- GROHE Long-Life finish
- GROHE SilkMove 46 mm ceramic cartridge
- pull-out laminar spray
- adjustable flow rate limiter
- swivel tubular spout
- swivel area 360°
- integrated non-return valve
- protected against backflow

- flexible connection hoses
- rapid installation system
- maximum flow rate (at 3 bar): 8 l/min
- optional temperature limiter (46 308 000)

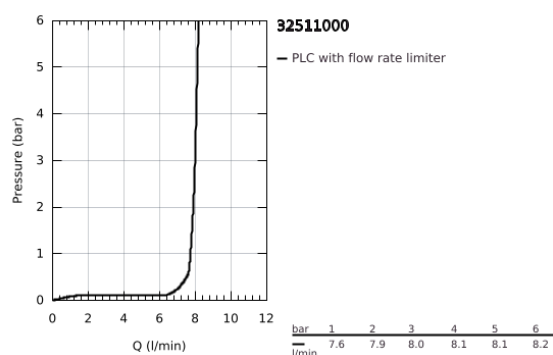

32 511 000 MINTA SINGLE-LEVER SINK MIXER 1/2"

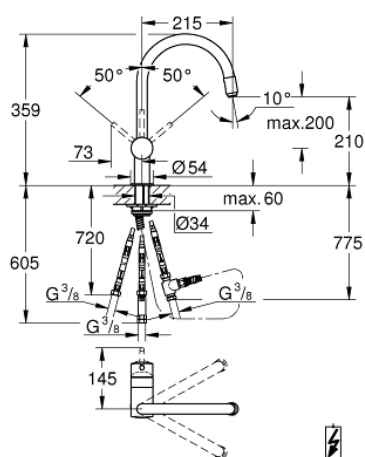
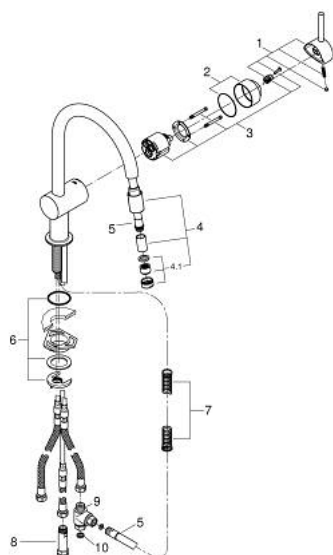

SPARE PARTS, June 2024 – now

- 1: Lever (Spare part-nr. 46015000)
- 2: Shield for cross handle (Spare part-nr. 46025000)
- 3: Cartridge (Spare part-nr. 46409000)
- 4: Extractable outlet (Spare part-nr. 46758000)
- 4.1: Flow straightener (Spare part-nr. 46162000)
- 5: Metal hose (Spare part-nr. 45352000)
- 6: Shank mounting kit (Spare part-nr. 46345000)
- 7: Compression spring (Spare part-nr. 07237000)
- 8: Non-return valve (Spare part-nr. 46323000)
- 9: Connection (Spare part-nr. 07202000)
- 10: Sealing washer (Spare part-nr. 0199700M)