

32 176 DC0 K7 SINGLE-LEVER SINK MIXER 1/2"

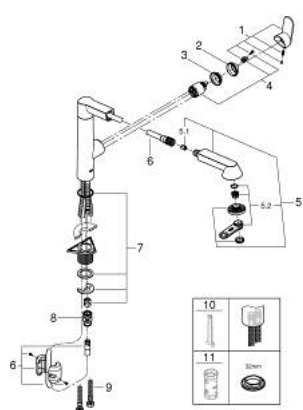

SPARE PARTS, March 2016 – now

- 1: Lever (Spare part-nr. 46729DC0)
- 2: Shield for cross handle (Spare part-nr. 46116DC0)
- 3: Screw coupling (Spare part-nr. 46460000)
- 4: Cartridge (Spare part-nr. 46374000)
- 5: Hand shower (Spare part-nr. 64156DC0)
- 5.1: Non-return valve (Spare part-nr. 08565000)
- 5.2: Flow restrictor (Spare part-nr. 46711000)
- 6: Hose for sink mixer with pull-out dual spray or mousseur (Spare part-nr. 48293000)
- 7: Shank mounting kit (Spare part-nr. 46346000)
- 8: Quick coupling (Spare part-nr. 46338000)
- 9: Flexible connection hose, 470 (Spare part-nr. 45484000)
- 10: Disassembling key (Spare part-nr. 19132000)*
- 11: Socket Spanner (Spare part-nr. 19332000)*
- * Optional accessories

32 176 DC0 **K7 SINGLE-LEVER SINK MIXER 1/2"**

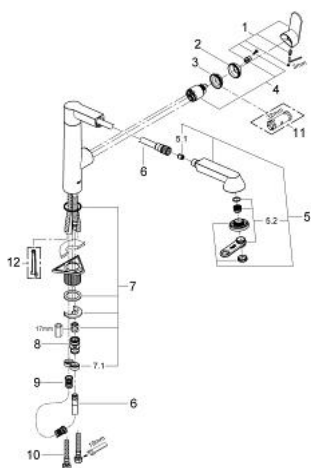

SPARE PARTS, July 2008 – March 2016

- 1: Lever (Spare part-nr. 46729DC0)
- 2: Shield for cross handle (Spare part-nr. 46116DC0)
- 3: Ring (Spare part-nr. 04456000)
- 4: Cartridge (Spare part-nr. 46374000)
- 5: Hand shower (Spare part-nr. 64156DC0)
- 5.1: Non-return valve (Spare part-nr. 08565000)
- 5.2: Flow restrictor (Spare part-nr. 46711000)
- 6: Shower hose (Spare part-nr. 46712000)
- 7: Shank mounting kit (Spare part-nr. 46346000)
- 7.1: Temperature limiter (Spare part-nr. 04174000)
- 8: Quick coupling (Spare part-nr. 46338000)
- 9: Compression spring (Spare part-nr. 07240000)
- 10: Flexible connection hose, 470 (Spare part-nr. 45484000)
- 11: Socket Spanner (Spare part-nr. 19332000)*
- 12: Disassembling key (Spare part-nr. 19132000)*

* Optional accessories