

32 175 DC0 **K7 SINGLE-LEVER SINK MIXER 1/2"**

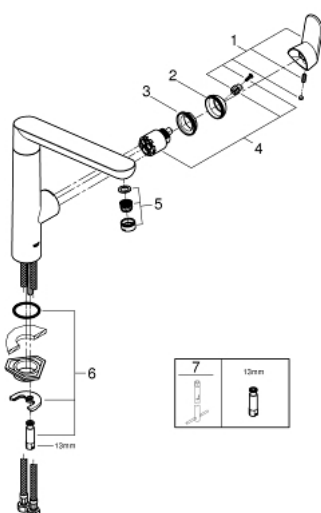

SPARE PARTS, August 2016 – now

- 1: Lever (Spare part-nr. 46729DC0)
- 2: Shield for cross handle (Spare part-nr. 46116DC0)
- 3: Screw coupling (Spare part-nr. 46460000)
- 4: Cartridge (Spare part-nr. 46374000)
- 5: Flow straightener (Spare part-nr. 46718DC0)
- 6: Shank mounting kit (Spare part-nr. 46671000)
- 7: Socket Spanner (Spare part-nr. 19332000)*
- 8: Mounting wrench (Spare part-nr. 19017000)*

* Optional accessories

32 175 DC0 **K7 SINGLE-LEVER SINK MIXER 1/2"**

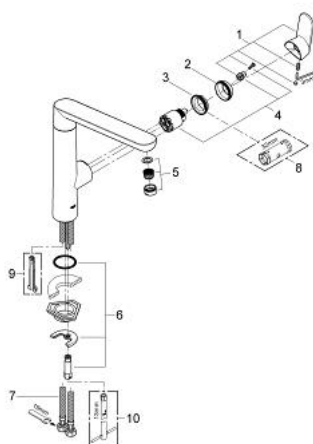

SPARE PARTS, July 2008 – August 2016

- 1: Lever (Spare part-nr. 46729DC0)
- 2: Shield for cross handle (Spare part-nr. 46116DC0)
- 3: Ring (Spare part-nr. 04456000)
- 4: Cartridge (Spare part-nr. 46374000)
- 5: Flow straightener (Spare part-nr. 46718DC0)
- 6: Shank mounting kit (Spare part-nr. 46671000)
- 7: Flexible connection hose, 470 (Spare part-nr. 45484000)
- 8: Socket Spanner (Spare part-nr. 19332000)*
- 9: Disassembling key (Spare part-nr. 19132000)*
- 10: Mounting wrench (Spare part-nr. 19017000)*

* Optional accessories