

30 978 000 HOSPITA SINK PILLAR TAP, 1/2"

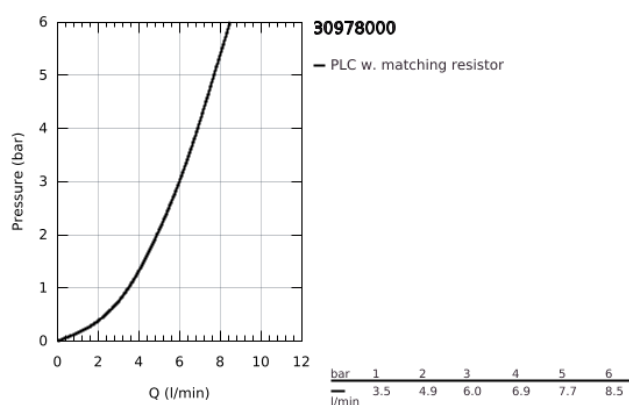

PRODUCT DESCRIPTION

- Colour: Chrome
- red/blue markers
- GROHE Long-Life finish

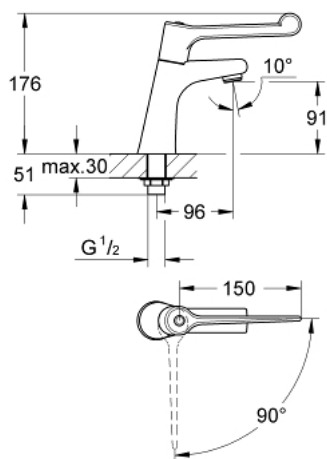

30 978 000 HOSPITA SINK PILLAR TAP, 1/2"

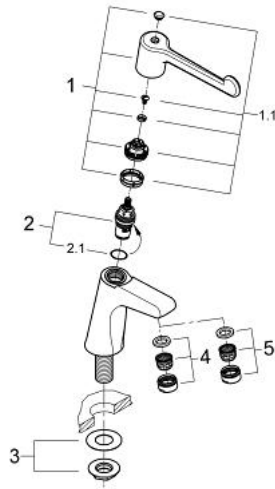

SPARE PARTS, March 2013 – now

- 1: Lever (Spare part-nr. 45314000)
- 1.1: Replacement handle connection kit (Spare part-nr. 45620000)
- 2: Ceramic headpart, 1/2" (Spare part-nr. 45883000)
- 2.1: O-Ring Ø18,2 x Ø1,7 (Spare part-nr. 0392400M)
- 3: Shank fastening assembly (Spare part-nr. 45000000)
- 4: Flow straightener (Spare part-nr. 13955000)
- 5: Strainer jet regulator
- Sistra M24x1 (Spare part-nr. 13905000)