

30 494 243 0 **START TWO HANDLE SINK MIXER**

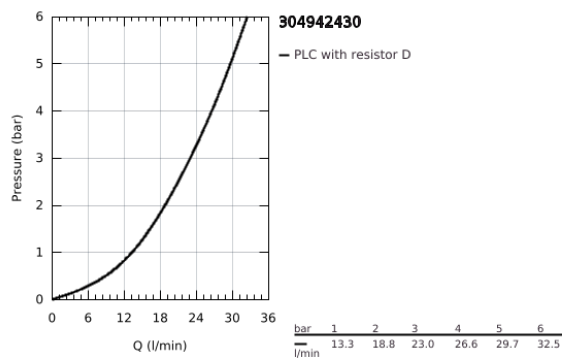

PRODUCT DESCRIPTION

- Colour: matte black
- high spout
- monobloc installation
- cartridge: ceramic head parts, 90° turn angle
- integrated temperature limiter
- mousseur
- swivel tubular spout
- adjustable swivel area 0° / 150° / 360°
- Lead and Nickel Free Inner Water Ways
- flexible connection hoses 1/2"
- min. recommended pressure 0.3 bar
- QuickMount included

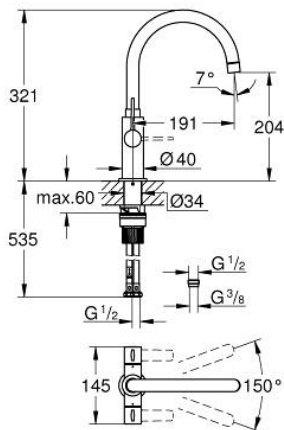

30 494 243 0 **START TWO HANDLE SINK MIXER**

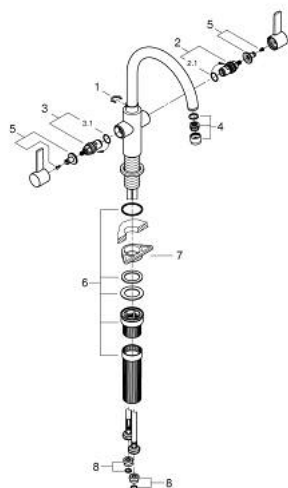

SPARE PARTS, May 2023 – now

- 1: Safety ring (Spare part-nr. 0485300M)
- 2: Ceramic headpart, 1/2" (Spare part-nr. 45882000)
- 2.1: O-Ring Ø18,2 x Ø1,7 (Spare part-nr. 0392400M)
- 3: Ceramic headpart, 1/2" (Spare part-nr. 45883000)
- 3.1: O-Ring Ø18,2 x Ø1,7 (Spare part-nr. 0392400M)
- 4: flow control (Spare part-nr. 481742430)
- 5: Replacement handle connection kit (Spare part-nr. 45605000)
- 6: Mounting set (Spare part-nr. 48477000)
- 7: Support plate (Spare part-nr. 05334000)
- 8: Adapter 1/2" x 3/8" (Spare part-nr. 12945000)