

30 215 DC0 **PARKFIELD SINGLE-LEVER SINK MIXER 1/2"**

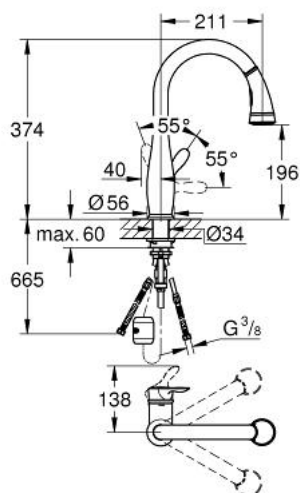

PRODUCT DESCRIPTION

- Colour: supersteel
- monobloc installation
- GROHE Long-Life finish
- GROHE SilkMove 35 mm ceramic cartridge
- pull-out dual spray control - switches between regular flow and spray
- diverter: mousseur/shower jet
- automatic return to mousseur
- adjustable flow rate limiter
- swivel tubular spout
- swivel area 360°
- integrated non-return valve
- protected against backflow
- flexible connection hoses



- rapid installation system
- min. recommended pressure 1.0 bar

30 215 DC0 **PARKFIELD SINGLE-LEVER SINK MIXER 1/2"**

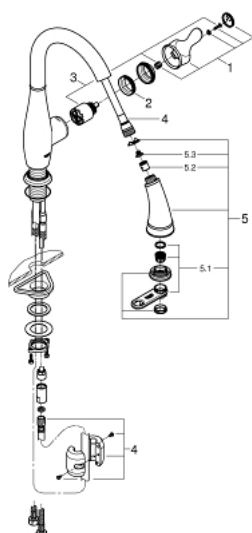

SPARE PARTS, June 2016 – now

- 1: Lever (Spare part-nr. 46889DC0)
- 2: Screw coupling (Spare part-nr. 46460000)
- 3: Cartridge (Spare part-nr. 46374000)
- 4: Hose for sink mixer with pull-out dual spray or mousseur (Spare part-nr. 48293000)
- 5: Hand shower (Spare part-nr. 46890ND0)
- 5.1: Flow restrictor (Spare part-nr. 46711000)
- 5.2: Non-return valve (Spare part-nr. 08565000)
- 5.3: Strainer (Spare part-nr. 0676800M)