

30 189 000 **AMBI TWO HANDLE SINK MIXER 1/2"**

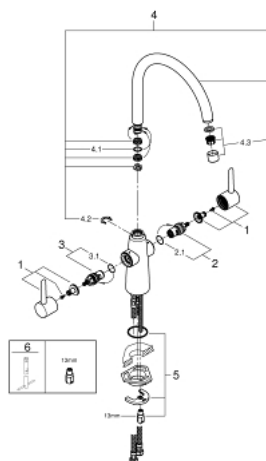

SPARE PARTS, August 2016 – now

- 1: handle neutral (Spare part-nr. 48172000)
- 2: Ceramic headpart, 1/2" (Spare part-nr. 45882000)
- 2.1: O-Ring Ø18,2 x Ø1,7 (Spare part-nr. 0392400M)
- 3: Ceramic headpart, 1/2" (Spare part-nr. 45883000)
- 3.1: O-Ring Ø18,2 x Ø1,7 (Spare part-nr. 0392400M)
- 4: Biflo spout (Spare part-nr. 13337000)
- 4.1: Sealing washer (Spare part-nr. 0128500M)
- 4.2: Safety ring (Spare part-nr. 0485300M)
- 4.3: Flow restrictor (Spare part-nr. 48174000)
- 5: Shank mounting kit (Spare part-nr. 46249000)
- 6: Mounting wrench (Spare part-nr. 19017000)*

* Optional accessories

30 189 000 **AMBI TWO HANDLE SINK MIXER 1/2"**

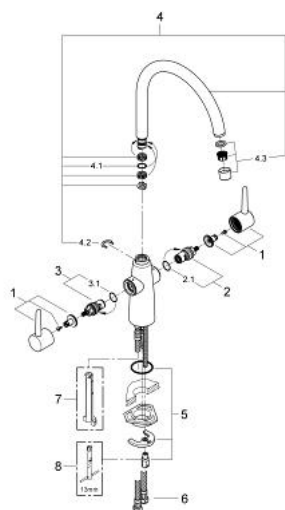

SPARE PARTS, May 2011 – August 2016

- 1: handle neutral (Spare part-nr. 48172000)
- 2: Ceramic headpart, 1/2" (Spare part-nr. 45882000)
- 2.1: O-Ring Ø18,2 x Ø1,7 (Spare part-nr. 0392400M)
- 3: Ceramic headpart, 1/2" (Spare part-nr. 45883000)
- 3.1: O-Ring Ø18,2 x Ø1,7 (Spare part-nr. 0392400M)
- 4: Biflo spout (Spare part-nr. 13337000)
- 4.1: Sealing washer (Spare part-nr. 0128500M)
- 4.2: Safety ring (Spare part-nr. 0485300M)
- 4.3: Flow restrictor (Spare part-nr. 48174000)
- 5: Shank mounting kit (Spare part-nr. 46249000)
- 6: Connection hose (Spare part-nr. 46322000)
- 7: Disassembling key (Spare part-nr. 19132000)*
- 8: Mounting wrench (Spare part-nr. 19017000)*

* Optional accessories