

29 805 000 **CONCEALED VALVE 1"**

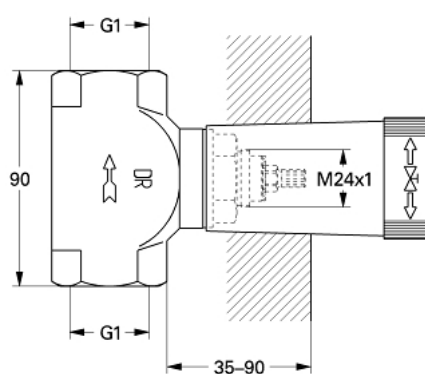

PRODUCT DESCRIPTION

- pre-assembled headpart 1"
- short spindle
- protection sleeve
- threaded union 1"
- DR-brass



29 805 000 **CONCEALED VALVE 1"**

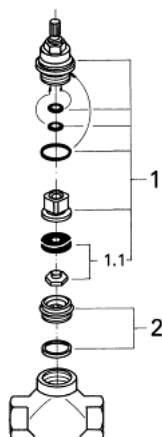

SPARE PARTS, January 1986 – now

1: Headpart 1", concealed valve (Spare part-nr. 07026000)

1.1: Seat washer and nut (Spare part-nr. 45074000)

2: Valve Seat (Spare part-nr. 45073000)