

29 802 000 **CONCEALED STOP VALVE 3/4"**

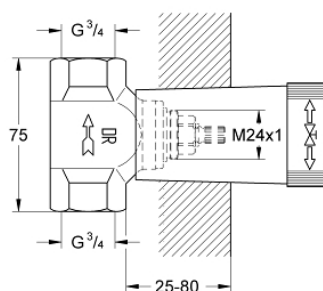

PRODUCT DESCRIPTION

- pre-assembled headpart 3/4"
- short spindle
- protection sleeve
- thread union 3/4"
- DR-brass



29 802 000 **CONCEALED STOP VALVE 3/4"**

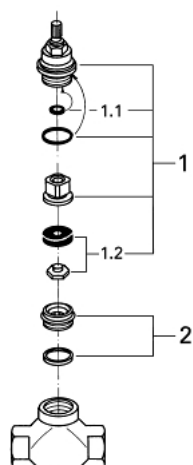

SPARE PARTS, July 2008 – now

1: Screw-down valve, 3/4" (Spare part-nr. 07025000)

1.1: O-Ring Ø6 x Ø2 (Spare part-nr. 0128300M)

2: renewable seat set 3/4" (Spare part-nr. 45052000)