

29 403 AL0 ALLURE BRILLIANT 2-HOLE BASIN MIXER L-SIZE

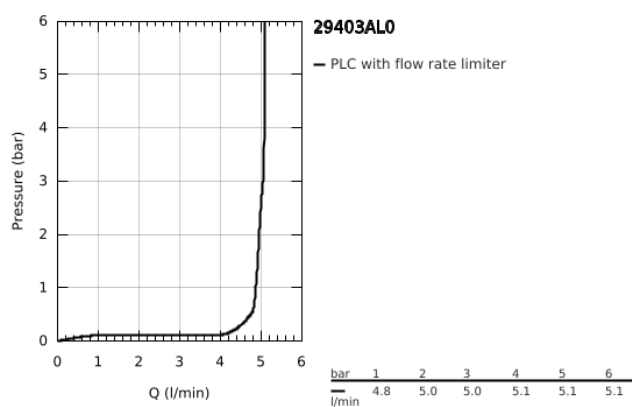

PRODUCT DESCRIPTION

- Colour: brushed hard graphite
- wall mounted
- without concealed body
- set for final installation for
- 23 200 000
- GROHE Long-Life finish
- GROHE Water Saving - Less water, perfect flow
- maximum flow rate (at 3 bar): 5 l/min
- spout with integrated mousseur
- centre distance 110 mm
- projection 210 mm
- min. recommended pressure 1.0 bar



29 403 AL0 **ALLURE BRILLIANT 2-HOLE BASIN MIXER** **L-SIZE**

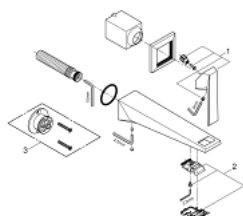

SPARE PARTS, October 2021 – now

1: Lever (Spare part-nr. 46797AL0)

2: Race (Spare part-nr. 46794AL0)

3: Flush pipe extension (Spare part-nr. 46627000)*

* Optional accessories