

## 29 025 002 TWO-HANDLE BASIN MIXER CONCEALED BODY, 1/2"

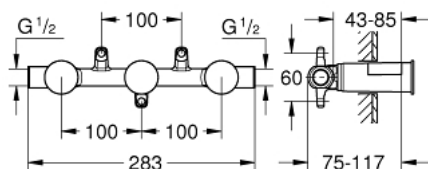

### PRODUCT DESCRIPTION

- for 3-hole basin mixer
- wall installation
- without finishing trim set
- DR-brass
- installation device
- allows for waterproofing of wall construction surrounding the concealed body
- with sealing sleeve



29 025 002 **TWO-HANDLE BASIN MIXER  
CONCEALED BODY, 1/2"**

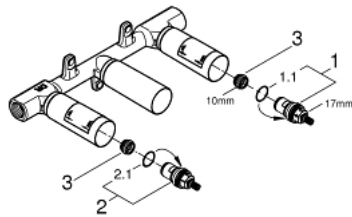

**SPARE PARTS**, June 2018 – now

1: Ceramic headpart, 1/2" (Spare part-nr. 45883000)

1.1: O-Ring Ø18,2 x Ø1,7 (Spare part-nr. 0392400M)

2: Ceramic headpart, 1/2" (Spare part-nr. 45882000)

2.1: O-Ring Ø18,2 x Ø1,7 (Spare part-nr. 0392400M)

3: Seat (Spare part-nr. 45023000)