

27 433 000 RAINSHOWER ICON SYSTEM 190 SHOWER SYSTEM WITH DIVERTER FOR WALL MOUNTING

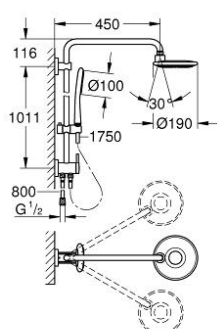

PRODUCT DESCRIPTION

- Colour: Chrome
- Consisting of:
 - horizontal swivable 450 mm projection shower arm
 - change between hand and head shower by using the diverter
 - head shower Icon (27 439 000)
 - chrome plated spray plate
 - with ball joint
 - rotation angle $\pm 15^\circ$
 - hand shower Icon 100 (27 377 000)
 - adjustable height via gliding element (12 140 000)
- GROHE EcoJoy 9.5 l/min flow rate
- connection to water supply with 1/2"-thread of the 800 mm shower hose to faucet / wall union
- Silverflex shower hose 1750 mm 1/2" x 1/2" (28 388 000)
- minimum flow rate 7 l/min.
- GROHE Water Saving - Less water, perfect flow
- GROHE DreamSpray perfect spray pattern
- GROHE Long-Life finish
- SpeedClean anti-limescale system
- suitable for instantaneous heaters from 18 kW/h



27 433 000 RAINSHOWER ICON SYSTEM 190 SHOWER SYSTEM WITH DIVERTER FOR WALL MOUNTING

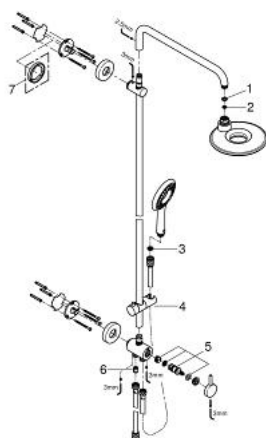

SPARE PARTS, November 2009 – now

- 1: Fibre seal dia. Ø 18,5 x Ø 12 x 2 (Spare part-nr. 0138900M)
- 2: Strainer (Spare part-nr. 48007000)
- 3: Strainer (Spare part-nr. 0700200M)
- 4: Sliding piece (Spare part-nr. 12140000)
- 5: Repl.kit f.rotary valve (Spare part-nr. 45915000)
- 6: Non-return valve (Spare part-nr. 08565000)
- 7: Spacer (Spare part-nr. 27180000)*

* Optional accessories