

25 216 001 **BAUEDGE TWO-HANDLED BATH FILLER 1/2"**

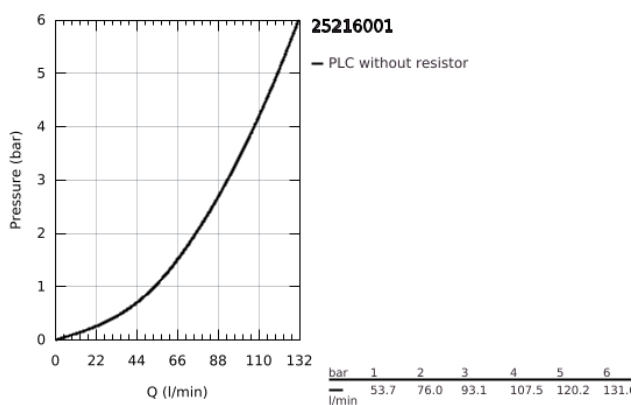

PRODUCT DESCRIPTION

- Colour: Chrome
- deck mounted
- metal lever
- Ceramic valves 3/4", 90°
- GROHE Long-Life finish
- Min. recommended pressure 0.5 bar

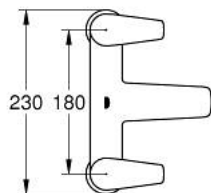
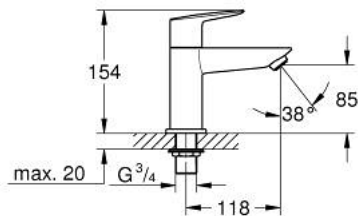

25 216 001 **BAUEDGE TWO-HANDLED BATH FILLER 1/2"**

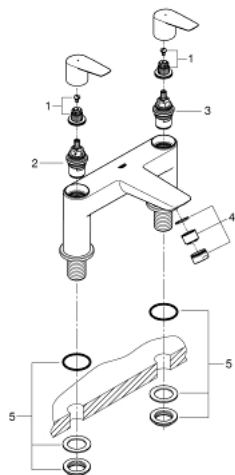

SPARE PARTS, September 2018 – now

1: Replacement handle connection kit (Spare part-nr. 45186000)

1.1: O-Ring Ø18,2 x Ø1,7 (Spare part-nr. 0392400M)

2: Ceramic headpart 3/4", 180° (Spare part-nr. 45887000)

3: Ceramic headpart 3/4", 180° (Spare part-nr. 45888000)

4: Flow restrictor (Spare part-nr. 13922000)

4.1: Sealing washer (Spare part-nr. 0263700M)

5: Repl.kit f.shank fastening 3/4" (Spare part-nr. 45163000)