

25 007 000 **SENTOSA BATH / SHOWER MIXER 1/2"**

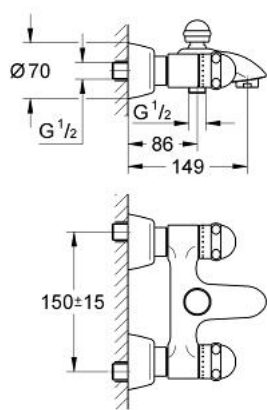

**PRODUCT DESCRIPTION**

- Colour: Chrome
- wall mounted
- ceramic headparts 1/2", 180°
- automatic diverter: bath/shower
- mousseur
- shower outlet 1/2"
- integrated non-return valve
- S-unions
- GROHE Long-Life finish

## 25 007 000 SENTOSA BATH / SHOWER MIXER 1/2"

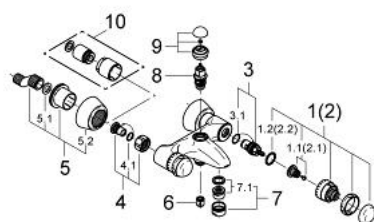

### SPARE PARTS, December 2004 – now

- 1: Handle 1/2" (Sentosa) (Spare part-nr. 45538IP0)
- 1.1: Replacement handle connection kit (Spare part-nr. 45186000)
- 1.1.1: O-Ring Ø18,2 x Ø1,7 (Spare part-nr. 0392400M)
- 1.2: Guide ring (Spare part-nr. 0202100M)
- 2: Sentosa handle, hot (Spare part-nr. 45539IP0)
- 2.1: Replacement handle connection kit (Spare part-nr. 45186000)
- 2.2: Guide ring (Spare part-nr. 0202100M)
- 3: Ceramic headpart, 1/2" (Spare part-nr. 45346000)
- 3.1: O-Ring Ø18,2 x Ø1,7 (Spare part-nr. 0392400M)
- 4: Screw joint (Spare part-nr. 45544000)
- 4.1: O-Ring Ø15 x Ø2 (Spare part-nr. 0311900M)
- 5: S-union (Spare part-nr. 12058000)
- 5.1: Sealing washer (Spare part-nr. 0138600M)
- 5.2: Covering escutcheon (Spare part-nr. 45545000)
- 6: Non-return valve (Spare part-nr. 08565000)
- 7: Flow restrictor (Spare part-nr. 13927000)
- 7.1: Repl.kit f.aerator M28x1 (Spare part-nr. 45029000)
- 8: Diverter (Spare part-nr. 08915000)
- 9: Diverter knob (Spare part-nr. 45547IP0)
- 10: Extension 30 (Spare part-nr. 46238000)\*

\* Optional accessories