

24 064 DC1 LINEARE SINGLE-LEVER MIXER WITH 2-WAY DIVERTER

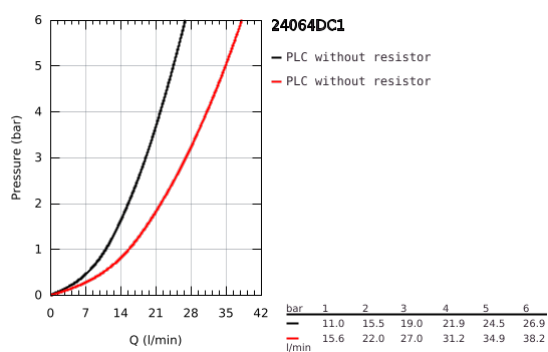

PRODUCT DESCRIPTION

- Colour: supersteel
- set for final installation for
- GROHE Rapido SmartBox 35 600/35 604
- GROHE SilkMove 46 mm ceramic cartridge
- GROHE Long-Life finish
- wall escutcheon with GROHE FastFixation(covered escutcheon- and shaft sealing, covered fixing)
- metal escutcheon, retroactively 6° adjustable
- metal lever
- automatic 2-way diverter
- flow performance: outlet B = 27 l/min, outlet C = 27 l/min
- without roughing-in-set

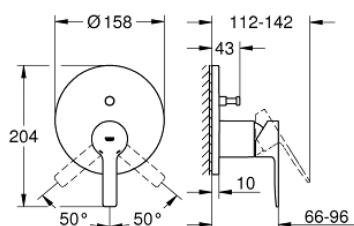

24 064 DC1 LINEARE SINGLE-LEVER MIXER WITH 2-WAY DIVERTER



SPARE PARTS, July 2017 – now

- 1: Lever (Spare part-nr. 46988DC0)
 - 2: Escutcheon (Spare part-nr. 48429DC0)
 - 3: Mounting plate (Spare part-nr. 48440000)
 - 4: Shield for cross handle (Spare part-nr. 09038DC0)
 - 5: Diverter (Spare part-nr. 48442DC0)
 - 6: Cartridge (Spare part-nr. 46048000)
 - 7: Non-return valve (Spare part-nr. 49085000)
 - 8: Sealing washer (Spare part-nr. 48360000)
 - 9: Temperature limiter (Spare part-nr. 46375000)*
 - 10: Backflow protection combination (DIN-EN1717) (Spare part-nr. 14055000)*
 - 11: Universal extension set single-lever mixers, 25 mm (Spare part-nr. 14056000)*
 - 12: Diverter (Spare part-nr. 48444DC0)*
 - 13: Universal extension set single-lever mixers, 50 mm (Spare part-nr. 14057000)*
 - 14: Diverter (Spare part-nr. 48445DC0)*
- * Optional accessories