

23 498 000 GET PILLAR TAP 1/2" XS-SIZE

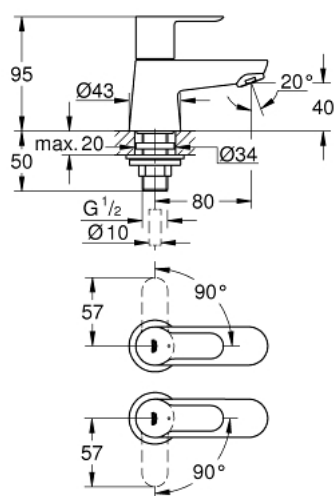

PRODUCT DESCRIPTION

- Colour: Chrome
- monobloc installation
- metal lever
- ceramic headpart
- GROHE Long-Life finish
- GROHE Water Saving - Less water, perfect flow
- mousseur
- 2 pieces
- min. recommended pressure 1.0 bar

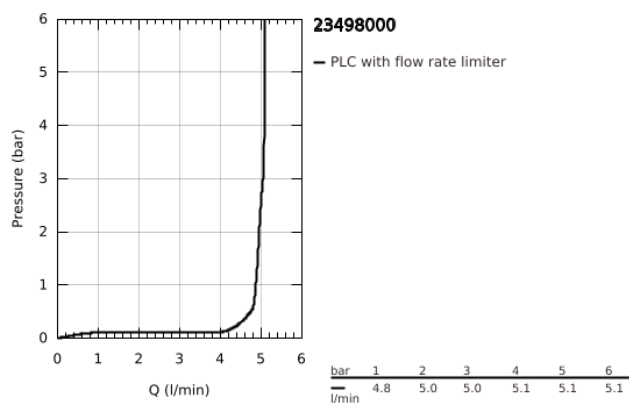

23 498 000 GET PILLAR TAP 1/2" XS-SIZE

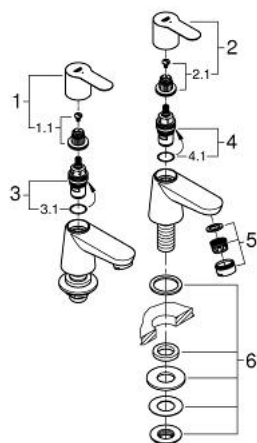

SPARE PARTS, January 2014 – now

- 1: BauEdge handle red (Spare part-nr. 48246000)
- 1.1: Replacement handle connection kit (Spare part-nr. 45186000)
- 1.1.1: O-Ring Ø18,2 x Ø1,7 (Spare part-nr. 0392400M)
- 2: Lever (Spare part-nr. 48028000)
- 2.1: Replacement handle connection kit (Spare part-nr. 45186000)
- 3: Ceramic headpart, 1/2" (Spare part-nr. 45883000)
- 3.1: O-Ring Ø18,2 x Ø1,7 (Spare part-nr. 0392400M)
- 4: Ceramic headpart, 1/2" (Spare part-nr. 45882000)
- 4.1: O-Ring Ø18,2 x Ø1,7 (Spare part-nr. 0392400M)
- 5: Flow straightener (Spare part-nr. 64450000)
- 6: Shank fastening assembly (Spare part-nr. 45000000)