

## 21 105 000 SENTOSA BASIN MIXER, 1/2"

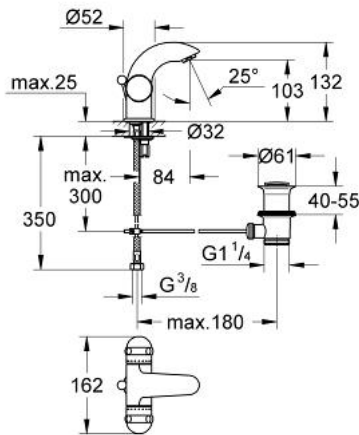

### PRODUCT DESCRIPTION

- Colour: Chrome
- ceramic headparts 1/2", 180°
- fixed cast spout with mousseur
- pop-up waste set 1 1/4"
- flexible connection hoses
- rapid installation system
- min. recommended pressure 1.0 bar
- GROHE Long-Life finish

## 21 105 000 SENTOSA BASIN MIXER, 1/2"

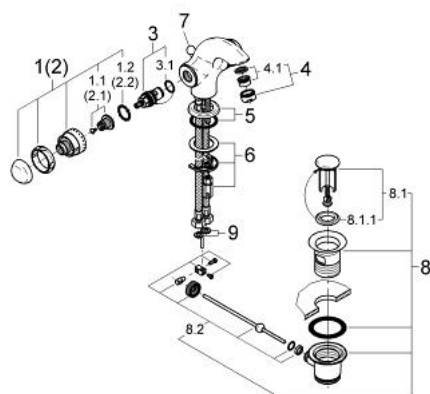

### SPARE PARTS, January 1993 – now

- 1: Sentosa handle, hot (Spare part-nr. 45539IP0)
- 1.1: Replacement handle connection kit (Spare part-nr. 45186000)
- 1.1.1: O-Ring Ø18,2 x Ø1,7 (Spare part-nr. 0392400M)
- 1.2: Guide ring (Spare part-nr. 0202100M)
- 2: Handle 1/2" (Sentosa) (Spare part-nr. 45538IP0)
- 2.1: Replacement handle connection kit (Spare part-nr. 45186000)
- 2.2: Guide ring (Spare part-nr. 0202100M)
- 3: Ceramic headpart, 1/2" (Spare part-nr. 45346000)
- 3.1: O-Ring Ø18,2 x Ø1,7 (Spare part-nr. 0392400M)
- 4: Flow restrictor (Spare part-nr. 13929000)
- 4.1: Repl.kit f.aerator M22x1 and M24x1 (Spare part-nr. 45002000)
- 5: Escutcheon (Spare part-nr. 45540000)
- 6: Shank mounting kit (Spare part-nr. 46249000)
- 7: Pop-up rod (Spare part-nr. 45541P00)
- 8: Pop-up waste set 1 1/4" (Spare part-nr. 28910000)
- 8.1: Chrome bath plug (Spare part-nr. 07182000)
- 8.2: Eccentric rod (Spare part-nr. 07052000)
- 9: Sealing washer (Spare part-nr. 0138300M)