

21 014 000 SINFONIA BASIN MIXER, 1/2"

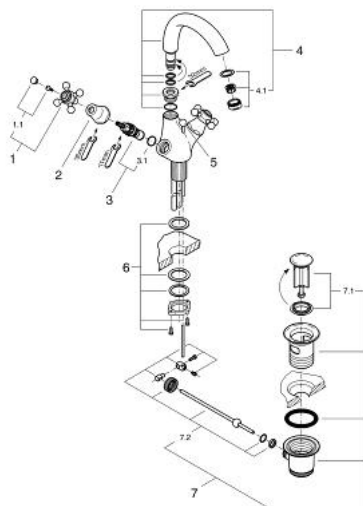

SPARE PARTS, July 2008 – now

- 1: Cross handle (Spare part-nr. 45291000)
- 1.1: Marking piece (Spare part-nr. 45305000)
- 2: Cover Cap (Spare part-nr. 00061000)
- 3: Ceramic headpart, 1/2" (Spare part-nr. 45346000)
- 3.1: O-Ring Ø18,2 x Ø1,7 (Spare part-nr. 0392400M)
- 4: Biflo spout (Spare part-nr. 13078000)
- 4.1: Flow restrictor (Spare part-nr. 13929000)
- 5: Pop-up rod (Spare part-nr. 07511000)
- 6: Shank mounting kit (Spare part-nr. 46078000)
- 7: Pop-up waste set 1 1/4" (Spare part-nr. 28910000)
- 7.1: Chrome bath plug (Spare part-nr. 07182000)
- 7.2: Eccentric rod (Spare part-nr. 07052000)

21 014 000 SINFONIA BASIN MIXER, 1/2"

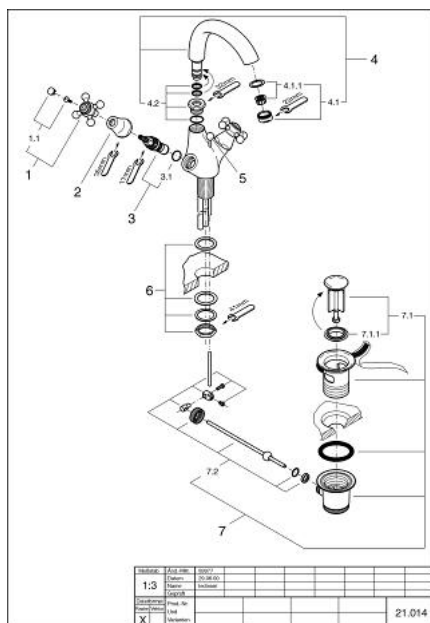

SPARE PARTS, January 2000 – July 2008

- 1: Cross handle (Spare part-nr. 45291000)
- 1.1: Marking piece (Spare part-nr. 45305000)
- 2: Cover Cap (Spare part-nr. 00061000)
- 3: Ceramic headpart, 1/2" (Spare part-nr. 45346000)
- 3.1: O-Ring Ø18,2 x Ø1,7 (Spare part-nr. 0392400M)
- 4: Biflo spout (Spare part-nr. 13078000)
- 4.1: Flow restrictor (Spare part-nr. 13929000)
- 5: Pop-up rod (Spare part-nr. 07511000)
- 6: Shank mounting kit (Spare part-nr. 46078000)
- 6.1: Support plate (Spare part-nr. 05334000)
- 7: Pop-up waste set 1 1/4" (Spare part-nr. 28910000)
- 7.1: Chrome bath plug (Spare part-nr. 07182000)
- 7.2: Eccentric rod (Spare part-nr. 07052000)