

20 661 DC0 ATRIO 3-HOLE BASIN MIXER M-SIZE

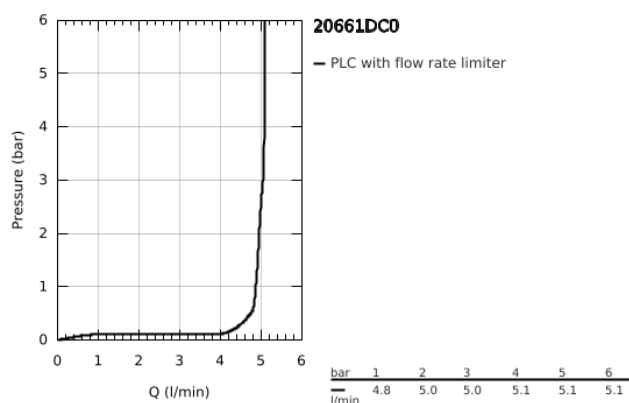
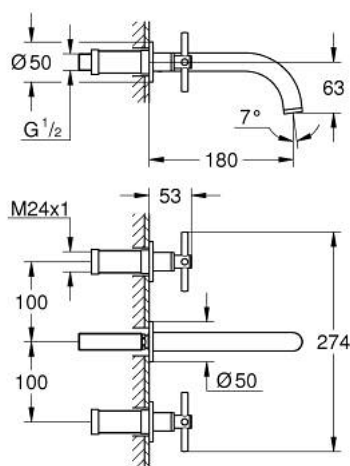

PRODUCT DESCRIPTION

- Colour: supersteel
- wall mounted
- set for final installation for
- 29 025 002
- valves hot/cold with headparts 1/2" - 90°
- GROHE Long-Life finish
- GROHE Water Saving - Less water, perfect flow
- maximum flow rate (at 3 bar): 5 l/min
- centre distance 200 mm
- projection 180 mm
- with cross handles
- without roughing-in set 29 025 002 (please order separately)
- Two different sets of caps included. One set with "H" and "C" marking, one set without marking.

20 661 DC0 **ATRIO 3-HOLE BASIN MIXER** **M-SIZE**

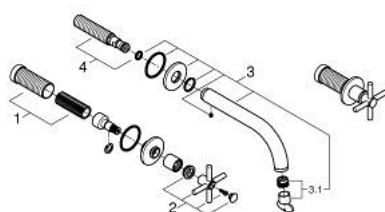

SPARE PARTS, October 2021 – now

1: Extension (Spare part-nr. 45988000)

2: Cross handles (Spare part-nr. 14215DC0)

3: Biflo spout (Spare part-nr. 101344DC00)

3.1: Flow straightener (Spare part-nr. 48408000)

4: union connection (Spare part-nr. 1013459990)