

20 575 000 BAUFLOW PILLAR TAP 1/2" XS-SIZE

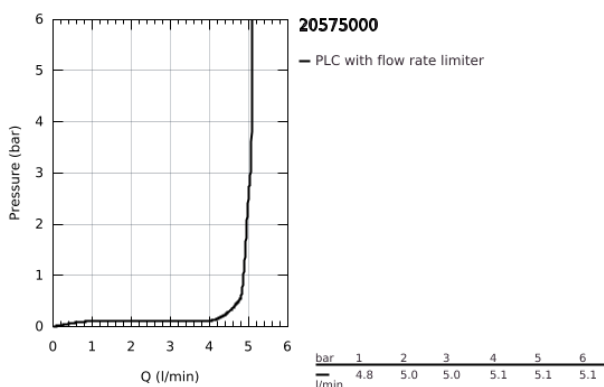

PRODUCT DESCRIPTION

- Colour: Chrome
- monobloc installation
- metal lever
- ceramic headpart
- GROHE Long-Life finish
- GROHE Water Saving mousseur 5.7 l/min
- fixation nut G 1/2"

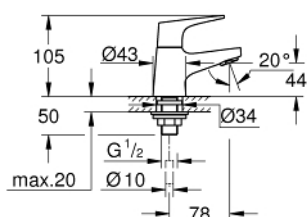

20 575 000 BAUFLOW PILLAR TAP 1/2" XS-SIZE

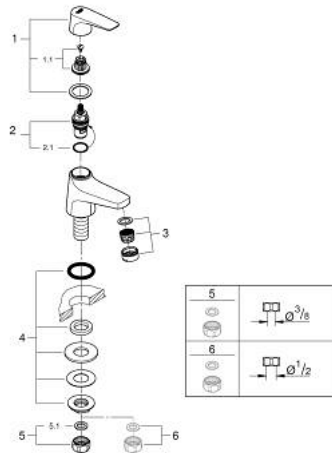

SPARE PARTS, May 2016 – now

- 1: Lever (Spare part-nr. 48030000)
- 2: Ceramic headpart, 1/2" (Spare part-nr. 45882000)
- 2.1: O-Ring Ø18,2 x Ø1,7 (Spare part-nr. 0392400M)
- 3: Flow restrictor (Spare part-nr. 48159000)
- 4: Shank mounting kit (Spare part-nr. 45004000)
- 5: Coupling nut 1/2" x 10.5 mm (Spare part-nr. 1290100M)
- 5.1: Fibre seal dia. Ø 18,5 x Ø 12 x 2 (Spare part-nr. 0138900M)
- 6: Coupling nut 1/2" x 14.5 mm (Spare part-nr. 1290200M)*

* Optional accessories