

20 014 IG0 SINFONIA THREE-HOLE BASIN MIXER 1/2"

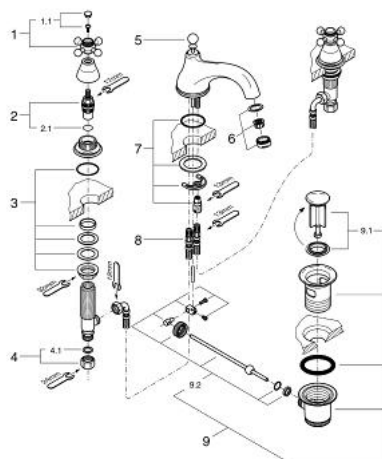

SPARE PARTS, July 2008 – now

- 1: Cross handle (Spare part-nr. 45291IG0)
- 1.1: Marking piece (Spare part-nr. 45305000)
- 2: Ceramic headpart, 1/2" (Spare part-nr. 45346000)
- 2.1: O-Ring Ø18,2 x Ø1,7 (Spare part-nr. 0392400M)
- 3: Shank fastening assembly (Spare part-nr. 45025000)
- 4: Coupling nut 1/2" x 10.5 mm (Spare part-nr. 1290100M)
- 4.1: Fibre seal dia. Ø 18,5 x Ø 12 x 2 (Spare part-nr. 0138900M)
- 5: Pop-up rod (Spare part-nr. 07511IG0)
- 6: Flow restrictor (Spare part-nr. 13929G00)
- 7: Fixing set (Spare part-nr. 45249000)
- 8: Flexible hose (Spare part-nr. 45461000)
- 9: Pop-up waste set 1 1/4" (Spare part-nr. 28910IG0)
- 9.1: Chrome bath plug (Spare part-nr. 07182G00)
- 9.2: Eccentric rod (Spare part-nr. 07052000)

20 014 IG0 SINFONIA THREE-HOLE BASIN MIXER 1/2"

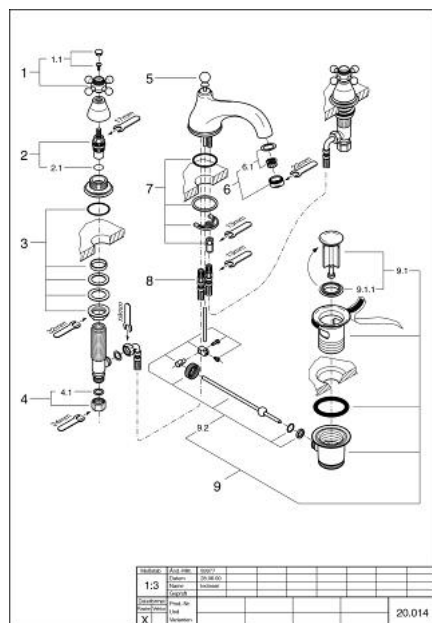

SPARE PARTS, January 2000 – July 2008

- 1: Cross handle (Spare part-nr. 45291IG0)
- 1.1: Marking piece (Spare part-nr. 45305000)
- 2: Ceramic headpart, 1/2" (Spare part-nr. 45346000)
- 2.1: O-Ring Ø18,2 x Ø1,7 (Spare part-nr. 0392400M)
- 3: Shank mounting kit (Spare part-nr. 45286000)
- 4: Coupling nut 1/2" x 10.5 mm (Spare part-nr. 1290100M)
- 4.1: Fibre seal dia. Ø 18,5 x Ø 12 x 2 (Spare part-nr. 0138900M)
- 5: Pop-up rod (Spare part-nr. 07511IG0)
- 6: Flow restrictor (Spare part-nr. 13929G00)
- 6.1: Repl. kit f. aerator M22x1 and M24x1 (Spare part-nr. 45002000)
- 7: Shank mounting kit (Spare part-nr. 45226000)
- 8: Flexible hose (Spare part-nr. 45461000)
- 9: Pop-up waste set 1 1/4" (Spare part-nr. 28910IG0)
- 9.1: Chrome bath plug (Spare part-nr. 07182G00)
- 9.2: Eccentric rod (Spare part-nr. 07052000)