

## 19 443 LS0 GROHE ONDUS THERMOSTATIC SHOWER MIXER

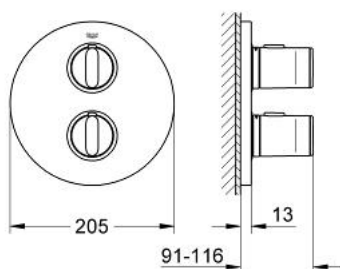

### PRODUCT DESCRIPTION

- Colour: moon white
- TMV2 compliant when used with 35 050 000
- set for final installation for
- GROHE Rapido T 35 500 000 / 35 050 000
- without concealed body
- volume handle with GROHE EcoButton (economy button with individually adjustable economy stop)
- temperature scale handle with GROHE SafeStop safety stop at 38°C ( calibration required )
- metal handles
- metal escutcheon
- escutcheon- and shaft-sealings
- covered fixing



## 19 443 LS0 GROHE ONDUS THERMOSTATIC SHOWER MIXER

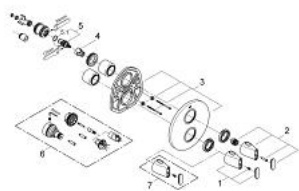

### SPARE PARTS, February 2007 – now

- 1: Handle for shut-off valve (Spare part-nr. 47794LS0)
- 2: Scale handle, metallic (Spare part-nr. 47795LS0)
- 3: Escutcheon (Spare part-nr. 47797LS0)
- 4: Temperature limiter (Spare part-nr. 10093000)
- 5: Ceramic headpart, 1/2" (Spare part-nr. 45346000)
- 5.1: O-Ring Ø18,2 x Ø1,7 (Spare part-nr. 0392400M)
- 6: Extension set 27.5 mm (Spare part-nr. 47780000)\*
- 7: Scale handle, metallic (Spare part-nr. 47798LS0)\*

\* Optional accessories