

19 442 000 **GROHE ONDUS THERMOSTAT WITH INTEGRATED 2-WAY DIVERTER
FOR BATH OR SHOWER WITH MORE THAN ONE OUTLET**

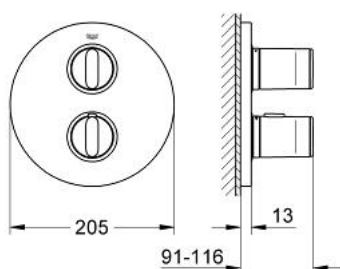

PRODUCT DESCRIPTION

- Colour: Chrome
- set for final installation for
- 35 050 000
- without concealed body
- temperature scale handle with GROHE SafeStop safety stop at 38°C (calibration required)
- Aquadimmer with multiple function
- shut off and flow control
- diverter for 2 outlets
- metal handles
- escutcheon- and shaft-sealings
- covered fixing



19 442 000 GROHE ONDUS THERMOSTAT WITH INTEGRATED 2-WAY DIVERTER FOR BATH OR SHOWER WITH MORE THAN ONE OUTLET



SPARE PARTS, April 2014 – now

- 1: Scale handle, metallic (Spare part-nr. 47795000)
- 2: Handle for shut-off valve (Spare part-nr. 47796000)
- 3: Stop ring (Spare part-nr. 10089000)
- 4: Escutcheon (Spare part-nr. 47797000)
- 5: Aquadimmer (Spare part-nr. 47364000)
- 6: Adapter (Spare part-nr. 12701000)
- 7: Extension set 27.5 mm (Spare part-nr. 47781000)*
- 8: Socket Spanner (Spare part-nr. 19332000)*
- 9: Scale handle, metallic (Spare part-nr. 47798000)*

* Optional accessories