

19 417 000 **GROHTHERM 2000 SPECIAL THERMOSTAT WITH INTEGRATED 2-WAY
DIVERTER**
FOR BATH OR SHOWER WITH MORE THAN ONE OUTLET

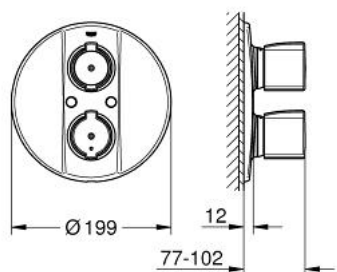

PRODUCT DESCRIPTION

- Colour: Chrome
- set for final installation for
- 35 050 000
- without concealed body
- metal wing handles
- GROHE Long-Life finish
- temperature scale handle with pre-adjustable metal safety stop between 35°C and 43°C (calibration required)
- easy thermal disinfection with accessory handle 47 764 000
- Aquadimmer with multiple function
- shut off and flow control
- diverter for 2 outlets
- escutcheon- and shaft-sealing
- metal escutcheon
- covered coupling



19 417 000 **GROHTHERM 2000 SPECIAL THERMOSTAT WITH INTEGRATED 2-WAY
DIVERTER
FOR BATH OR SHOWER WITH MORE THAN ONE OUTLET**

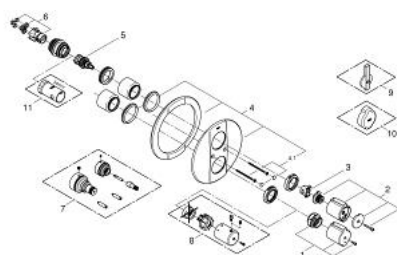

SPARE PARTS, April 2014 – now

- 1: Temperature knob with metal end stop (Spare part-nr. 47733000)
- 2: Aquadimmer handle (Spare part-nr. 47779000)
- 3: Stop ring (Spare part-nr. 10089000)
- 4: Escutcheon (Spare part-nr. 47749000)
- 4.1: set of screws (Spare part-nr. 46088000)
- 5: Aquadimmer (Spare part-nr. 47364000)
- 6: Adapter (Spare part-nr. 12701000)
- 7: Extension set 27.5 mm (Spare part-nr. 47781000)*
- 8: Metal handle temperature control (Spare part-nr. 47763000)*
- 9: Handle for disabled use (Spare part-nr. 47735000)*
- 10: Unlocking handle (Spare part-nr. 47764000)*
- 11: Socket Spanner (Spare part-nr. 19332000)*

* Optional accessories