

## 10 220 524 30 GROHTHERM 800 THERMOSTATIC BATH MIXER 1/2", 160CC

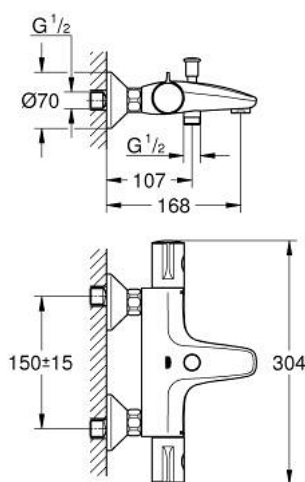

### PRODUCT DESCRIPTION

- Colour: matte black
- wall mounted
- GROHE SafeStop safety button at 38°C(calibration required)
- GROHE SafeStop Plus integrated temperature limiter at max 50°C
- GROHE Turbostat C3 compact cartridge with wax thermoelement
- integrated mixed water shut off
- automatic diverter: bath/shower
- volume handle with GROHE EcoButton(economy button with individually adjustable economy stop)
- ceramic headpart 1/2", 180°
- shower bottom outlet 1/2"
- mousseur
- built-in non return valves
- dirt strainers
- protected against backflow
- S-unions
- metal escutcheon
- GROHE Water Saving - Less water, perfect flow

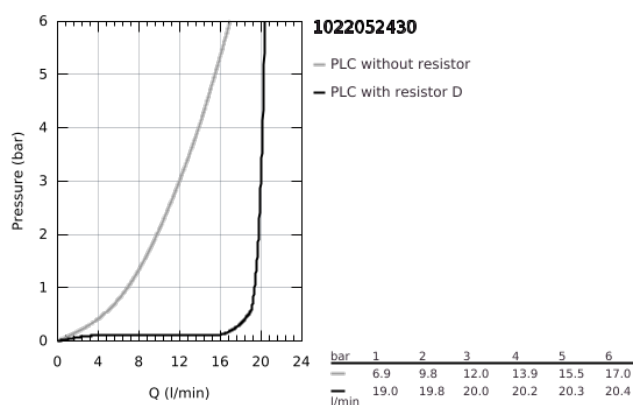

## 10 220 524 30 GROHTHERM 800 THERMOSTATIC BATH MIXER 1/2", 160CC

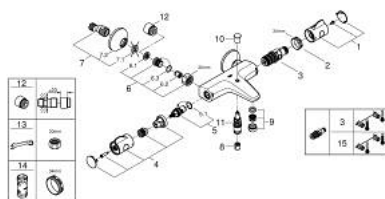

### SPARE PARTS, February 2023 – now

- 1: GRT 800 temperature control handle (Spare part-nr. 479822430)
- 2: retaining ring (Spare part-nr. 47743000)
- 3: Thermostatic compact cartridge 1/2" (Spare part-nr. 47885000)
- 4: GRT 800 shut-off handle (Spare part-nr. 479802430)
- 5: Ceramic headpart, 1/2" (Spare part-nr. 45346000)
- 5.1: O-Ring Ø18,2 x Ø1,7 (Spare part-nr. 0392400M)
- 6: Non-return valve (Spare part-nr. 471892430)
- 6.1: Filter (Spare part-nr. 0726400M)
- 6.2: Non-return valve (Spare part-nr. 08565000)
- 6.3: O-Ring Ø17 x Ø2 (Spare part-nr. 0305500M)
- 7: S-union (Spare part-nr. 120752430)
- 7.1: Sealing washer (Spare part-nr. 0138600M)
- 7.2: Escutcheon (Spare part-nr. 02210243M)
- 8: Non-return valve (Spare part-nr. 47886000)
- 9: Flow restrictor (Spare part-nr. 139412430)
- 10: Diverter knob (Spare part-nr. 656482430)
- 11: Diverter (Spare part-nr. 656552430)
- 12: Extension 3/4", 20 mm (Spare part-nr. 0713000M)\*
- 13: Special Spanner (Spare part-nr. 19377000)\*
- 14: Socket Spanner (Spare part-nr. 19332000)\*
- 15: GROHE TurboStat cartridge 1/2" (Spare part-nr. 47175000)\*

\* Optional accessories