

36 098 000 ALLURE E INFRA-RED ELECTRONIC BASIN MIXER 1/2" WITH MIXING DEVICE AND ADJUSTABLE TEMPERATURE LIMITER

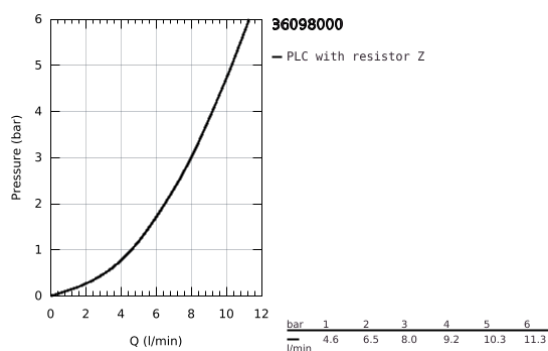
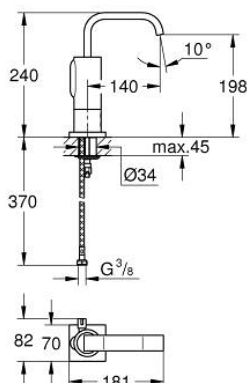

PRODUCT DESCRIPTION

- Colour: Chrome
- monobloc installation
- 6V lithium battery, type CR-P2
- GROHE Long-Life finish
- GROHE Water Saving 6.0 l/min. flow limiter
- integrated mousseur
- solenoid valve integrated in housing
- flexible connection hoses
- dirt strainer
- rapid installation system
- multistage battery status display
- automatically stops after 60 sec. (factory set)
- additional functions and precise settings by remote control 36 407
- automatic flushing after 1 or 3 days without use
- CE approved
- noise classification 1 in accordance with DIN4109
- type of protection faucet IP 59K

36 098 000 ALLURE E INFRA-RED ELECTRONIC BASIN MIXER 1/2" WITH MIXING DEVICE AND ADJUSTABLE TEMPERATURE LIMITER

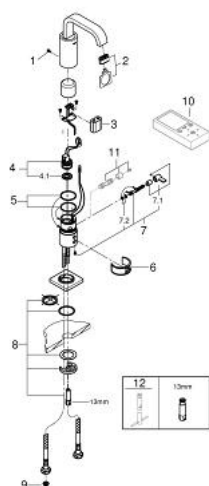

SPARE PARTS, June 2016 – now

- 1: Screw (Spare part-nr. 4283100M)
 - 2: Flow restrictor (Spare part-nr. 13220000)
 - 3: Battery (Spare part-nr. 42886000)
 - 4: Solenoid valve (Spare part-nr. 42229000)
 - 4.1: Filter (Spare part-nr. 42798000)
 - 5: O-Ring (Spare part-nr. 4283600M)
 - 6: Cleaning clip (Spare part-nr. 42837000)
 - 7: Lever (Spare part-nr. 42363000)
 - 7.1: Mixing lever (Spare part-nr. 42364000)
 - 7.2: O-Ring (Spare part-nr. 4284000M)
 - 8: Fixing set (Spare part-nr. 42841000)
 - 9: Filter (Spare part-nr. 4241300M)
 - 10: Remote control (Spare part-nr. 36407001)*
 - 11: Security cover cap (Spare part-nr. 36209000)*
 - 12: Mounting wrench (Spare part-nr. 19017000)*
- * Optional accessories