

## 34 011 000 ATRIO THERMOSTATIC SHOWER MIXER 1/2"

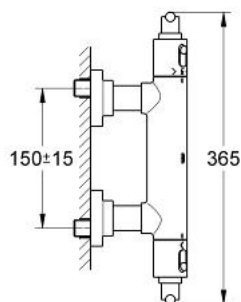
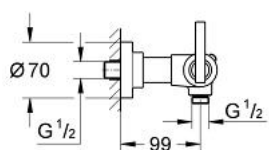

### PRODUCT DESCRIPTION

- Colour: Chrome
- wall mounted
- wax thermoelement
- integrated mixed water shut off
- ceramic headpart 1/2", 180°
- volume handle with GROHE EcoButton (economy button with individually adjustable economy stop)
- temperature scale handle with GROHE SafeStop safety stop at 38°C ( calibration required )
- shower outlet 1/2"
- built-in non return valves
- dirt strainers
- covered S-unions
- protected against backflow
- with Jota handle
- without shower set
- GROHE Long-Life finish
- GROHE Water Saving - Less water, perfect flow

## 34 011 000 ATRIO THERMOSTATIC SHOWER MIXER 1/2"

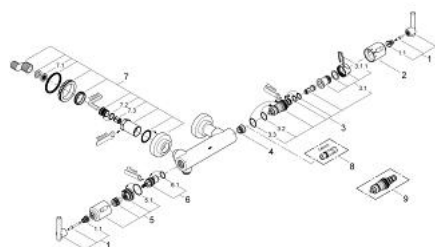

### SPARE PARTS, August 2008 – now

- 1: Handle Jota (Spare part-nr. 47324000)
- 1.1: Snap insert (Spare part-nr. 08943000)
- 2: Temperature scale handle (Spare part-nr. 06676000)
- 3: Thermo-element (Spare part-nr. 47217000)
- 3.1: Stop ring and regulating nut (Spare part-nr. 47300000)
- 3.1.1: Fixing clamp (Spare part-nr. 0574400M)
- 3.2: O-Ring Ø21 x Ø2 (Spare part-nr. 0599900M)
- 3.3: O-Ring Ø24 x Ø2 (Spare part-nr. 0119600M)
- 4: Thermostat seat (Spare part-nr. 01460000)
- 5: Handle for shut-off valve (Spare part-nr. 47311000)
- 5.1: O-Ring Ø31 x Ø2 (Spare part-nr. 0354000M)
- 6: Ceramic headpart, 1/2" (Spare part-nr. 45346000)
- 6.1: O-Ring Ø18,2 x Ø1,7 (Spare part-nr. 0392400M)
- 7: Screw joint (Spare part-nr. 47323000)
- 7.1: Filter (Spare part-nr. 0726400M)
- 7.2: O-Ring Ø17 x Ø2 (Spare part-nr. 0305500M)
- 7.3: Non-return valve (Spare part-nr. 08565000)
- 8: Socket Spanner (Spare part-nr. 19070000)\*
- 9: Thermostatic cartridge for reverse waterways (Spare part-nr. 47657000)\*

\* Optional accessories