

## 27 004 000 FREEHANDER SHOWER SYSTEM FOR WALL MOUNTING

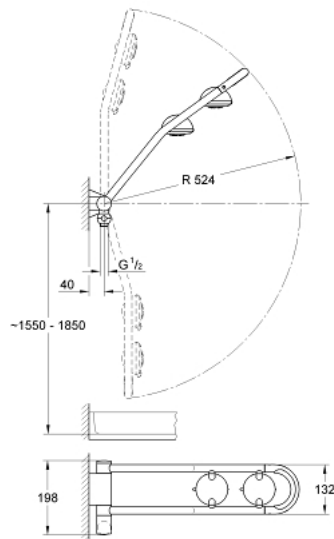

### PRODUCT DESCRIPTION

- Colour: Chrome
- with two rotating shower heads
- adjustable for use as head or side shower
- 1 shower head with wide, Pulsator and Eco spray
- 1 shower head with wide and pulsator spray
- lockable
- both heads with SpeedClean anti lime-scale system
- self stopping joint
- Grohclick elements for shower hose and handshower
- GROHE Long-Life finish



## 27 004 000 FREEHANDER SHOWER SYSTEM FOR WALL MOUNTING

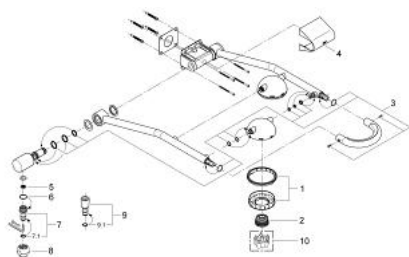

### SPARE PARTS, June 2007 – now

- 1: Spray faceplate (Spare part-nr. 45877P00)
- 2: Pulsator element (Spare part-nr. 45656XX0)
- 3: Replacement kit for seal (Spare part-nr. 45878000)
- 4: Cover Cap (Spare part-nr. 45879000)
- 5: Strainer (Spare part-nr. 0700200M)
- 6: O-Ring Ø18,2 x Ø1,7 (Spare part-nr. 0392400M)
- 7: Coupling piece (Spare part-nr. 28635XX0)
- 7.1: O-ring dia 11x2 mm (Spare part-nr. 0122400M)
- 8: Quick coupling (Spare part-nr. 45899000)
- 9: Nipple (Spare part-nr. 45900000)
- 9.1: O-ring dia 11x2 mm (Spare part-nr. 0122400M)
- 10: Disassembling key (Spare part-nr. 45654000)\*

\* Optional accessories