

## 23 395 10E EUROSMART BASIN MIXER 1/2" M-SIZE

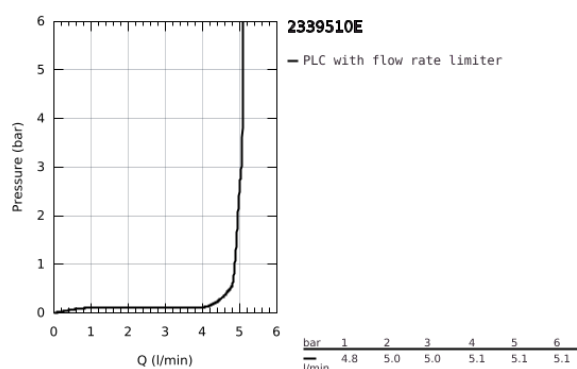

### PRODUCT DESCRIPTION

- Colour: Chrome
- monobloc installation
- metal lever
- GROHE SilkMove Energy Saving 28 mm ceramic cartridge with energy saving function via cold start
- with temperature limiter
- GROHE Long-Life finish
- GROHE Water Saving - Less water, perfect flow
- maximum flow rate (at 3 bar): 5 l/min
- GROHE FastFixation installation system
- smooth body
- flexible connection hoses

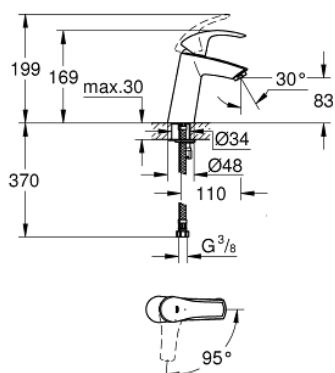

23 395 10E **EUROSMART BASIN MIXER 1/2"**  
**M-SIZE**



**SPARE PARTS**, December 2012 – now

- 1: Lever (Spare part-nr. 46865000)
  - 2: retaining ring (Spare part-nr. 46715000)
  - 3: Cartridge (Spare part-nr. 46580000)
  - 4: Flow restrictor (Spare part-nr. 48159000)
  - 5: Shank mounting kit (Spare part-nr. 46249000)
  - 6: Mounting wrench (Spare part-nr. 19017000)\*
- \* Optional accessories