

## 20 421 000 BAUEDGE PILLAR TAP 1/2" XS-SIZE

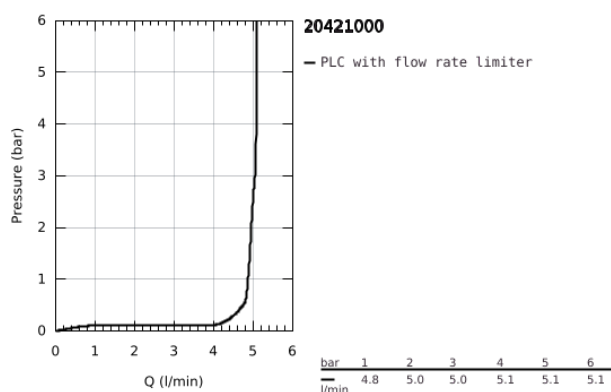

### PRODUCT DESCRIPTION

- Colour: Chrome
- monobloc installation
- metal lever
- ceramic headpart
- GROHE Long-Life finish
- GROHE Water Saving - Less water, perfect flow
- maximum flow rate (at 3 bar): 5 l/min
- fixation nut G 1/2"

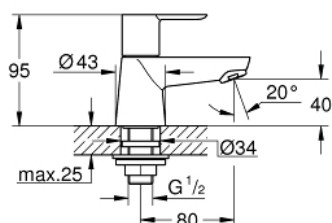

20 421 000 **BAUEDGE PILLAR TAP 1/2" XS-SIZE**

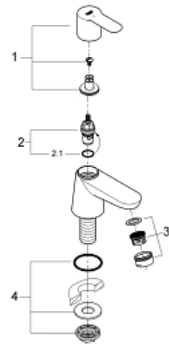

**SPARE PARTS**, September 2012 – now

1: Lever (Spare part-nr. 48028000)

1.1: Replacement handle connection kit (Spare part-nr. 45186000)

1.1.1: O-Ring Ø18,2 x Ø1,7 (Spare part-nr. 0392400M)

2: Ceramic headpart, 1/2" (Spare part-nr. 45882000)

2.1: O-Ring Ø18,2 x Ø1,7 (Spare part-nr. 0392400M)

3: Flow restrictor (Spare part-nr. 13952000)

4: Shank mounting kit (Spare part-nr. 45004000)