

## 19 442 LS0 GROHE ONDUS THERMOSTAT WITH INTEGRATED 2-WAY DIVERTER FOR BATH OR SHOWER WITH MORE THAN ONE OUTLET

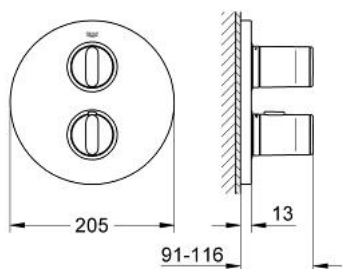

### PRODUCT DESCRIPTION

- Colour: moon white
- set for final installation for
- 35 050 000
- without concealed body
- temperature scale handle with GROHE SafeStop safety stop at 38°C ( calibration required )
- Aquadimmer with multiple function
- shut off and flow control
- diverter for 2 outlets
- metal handles
- metal escutcheon
- escutcheon- and shaft-sealings
- covered fixing



## 19 442 LS0 GROHE ONDUS THERMOSTAT WITH INTEGRATED 2-WAY DIVERTER FOR BATH OR SHOWER WITH MORE THAN ONE OUTLET

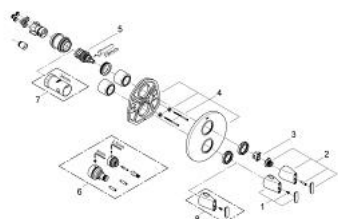

### SPARE PARTS, February 2007 – now

- 1: Scale handle, metallic (Spare part-nr. 47795LS0)
- 2: Handle for shut-off valve (Spare part-nr. 47796LS0)
- 3: Stop ring (Spare part-nr. 10089000)
- 4: Escutcheon (Spare part-nr. 47797LS0)
- 5: Aquadimmer (Spare part-nr. 47364000)
- 6: Extension set 27.5 mm (Spare part-nr. 47781000)\*
- 7: Socket Spanner (Spare part-nr. 19332000)\*
- 8: Scale handle, metallic (Spare part-nr. 47798LS0)\*

\* Optional accessories